

Repair Parts for Check-Mate[®] 100cc Displacement Pumps

312467E
EN

With priming piston and Severe Duty[®] or MaxLife[®] rod and cylinder.



Important Safety Instructions

Read all warnings and instructions in manual 312375. Save those instructions.



See manual 312375 for complete disassembly and reassembly instructions.

Parts

Ref.	Part	Description	Qty.	Ref.	Part	Description	Qty.
1	★✱255569	KIT, rod, displacement; chrome (includes 18, 21)	1	25	★✱184122	GUIDE, piston	1
	✱✱255570	KIT, rod, displacement; MaxLife (includes 18, 21)	1		✱✱15U598	GUIDE, piston; sst	1
2	★✱255604	KIT, housing, outlet, (150 mm) (includes 18, 21, 44, 47, 49, 52)	1	26	★✱184051	PISTON	1
	✱✱257561	KIT, housing, outlet, (150 mm); sst (includes 18, 21, 44, 47, 49, 52)	1		✱✱15U597	PISTON; sst	1
3	★✱15K751	CARTRIDGE	1	27	★✱184121	NUT, shovel	1
	✱✱15U603	CARTRIDGE; sst	1		✱✱15U596	NUT, shovel; sst	1
4‡	104361	O-RING, cartridge	1	28	★✱15M518	GUIDE, piston	1
5‡	★✱	GLAND, packing female; see Packing Kits	1		✱✱15U589	GUIDE, piston; sst	1
	✱✱	GLAND, packing, u-cup; see Packing Kits		29‡		BEARING, guide	1
6‡	★✱	V-PACKING; UHMWPE; see Packing Kits	3	30‡		SEAT, piston	1
	✱✱	SPACER, u-cup; see Packing Kits	1	31‡		SEAL, piston	1
7‡	★✱	V-PACKING; PTFE; see Packing Kits	2	32‡		VALVE, intake	1
	✱✱	SPACER, u-cup; acetal; see Packing Kits	1	33‡		NUT, packing	1
8‡	★✱	GLAND, packing male; see Packing Kits	1	34‡		GLAND, male, piston; see Packing Kits	1
9‡	★✱	NUT, packing, open wet cup	1	35‡		PACKING, UHMWPE; see Packing Kits	2
	✱✱	CUP, wet, enclosed	1	36‡	✱✱	PACKING; leather; see Packing Kits	2
10‡	✱✱	COVER, wet cup	1		★✱	PACKING, PTFE; see Packing Kits	2
11‡	✱✱161446	O-RING	1	37‡		GLAND, female, piston; see Packing Kits	1
12‡	✱✱	SIGHTGLASS	1	38‡		SEAL, valve	1
13‡	✱✱	COVER, oil hole	1	39‡		HOUSING, valve	1
14‡	✱✱	SCREW, socket hd cap; M5 x 12	3	40‡		PLUG, valve	1
15‡	✱✱	WIPER, wet cup cover	1	41‡		HANDLE, outlet bleed	1
16‡	✱✱	SEAL, wet cup cover	1	42‡		CLIP, outlet bleed	1
17‡	★✱	CYLINDER, pump	1	43	★✱184037	FITTING, outlet	1
	✱✱	CYLINDER, pump, MaxLife	1		✱✱15U592	FITTING, outlet; sst	1
18‡	109205	O-RING	2	44‡	110135	O-RING	1
19	★✱184044	HOUSING, valve	1	47▲	184090	LABEL, warning	1
	✱✱15U586	HOUSING, valve; sst	1	48▲	184151	LABEL, warning	1
20‡		SEAT, intake	1	49	100508	SCREW, drive	7
21‡		SEAL	1	50▲	172479	TAG, instruction, safety	1
22	★✱255610	KIT, intake housing, cylinder (includes 21, 48, 49)	1	51‡	✱✱	PLUG, pipe	1
	✱✱257560	KIT, intake housing, cylinder; sst (includes 21, 48, 49)	1	52‡	197561	PLATE, identification	1
23‡		SEAT, piston	1	61	✱✱15T825	RING, retaining	1
24‡	★✱	ROD, piston	1				
	✱✱	ROD, piston; MaxLife	1				

★ *Model L100CS only.*

✱ *Model L100SS only.*

✱ *Model L100CM only.*

✱ *Model L100SM only.*

‡ *See table.*

▲ *Replacement Danger and Warning labels, tags, and cards are available at no cost.*

KEY:

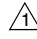
 Torque to 85-95 ft-lb (115-128 N•m)

 Torque to 28-44 ft-lb (38-59 N•m)

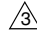
 Torque to 213-287 ft-lb (288-387 N•m)

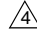
 Torque to 43-47 ft-lb (58-63 N•m)

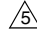
 Torque to 34-38 ft-lb (45-51 N•m)

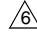
 Torque to 26-30 ft-lb (35-41 N•m)

 Torque to 90-130 ft-lb (122-173 N•m)

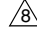
 Torque to 44-62 ft-lb (60-84 N•m)

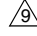
 Apply thread sealant

L: Piston Check Valve Assembly (includes 23)

M: Throat Packings

N: Intake Valve Packings

Lubricate all soft seal components before installation.

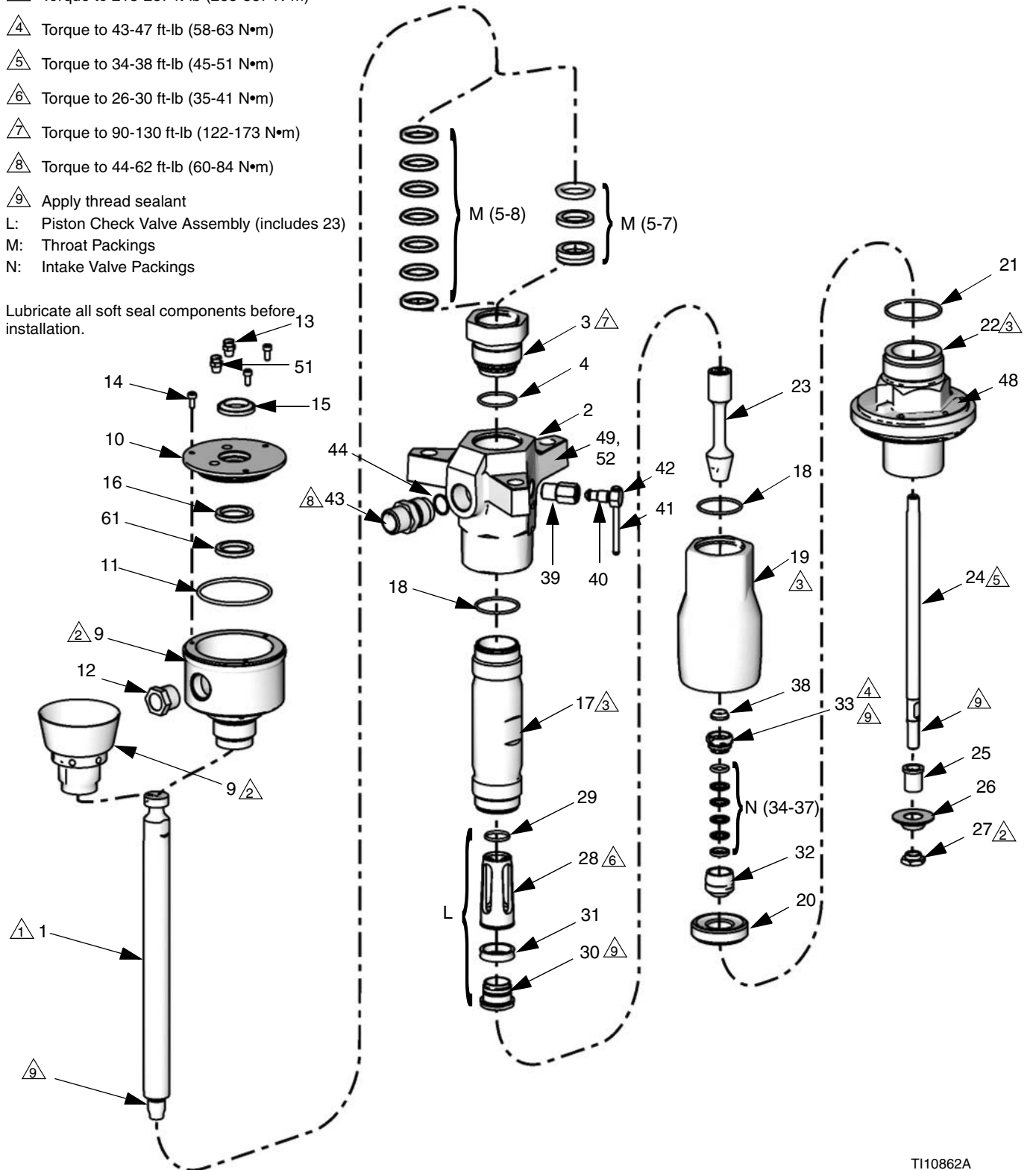

TI10862A

Kits

The following table indicates which parts (according to reference number) are included in each kit.

Kit	Reference Numbers																																																												
	4	5	6	7	8	9	10	11	12	13	14	15	16	17	18	20	21	23	24	29	30	31	32	33	34	35	36	37	38	39	40	41	42	44	51	61																									
255507	✓	✓	✓	✓	✓										✓		✓			✓		✓				✓	✓	✓	✓	✓																	✓														
256866	✓	✓	✓	✓	✓										✓		✓			✓		✓				✓	✓	✓	✓	✓																		✓													
255508	✓	✓	✓	✓					✓				✓	✓	✓		✓			✓		✓				✓	✓	✓	✓	✓																	✓		✓												
256867	✓	✓	✓	✓					✓				✓	✓	✓		✓			✓		✓				✓	✓	✓	✓	✓																	✓		✓												
255523	✓	✓	✓	✓	✓																																																								
255524	✓	✓	✓	✓					✓				✓	✓																																					✓										
257558	✓	✓	✓	✓					✓				✓	✓																																					✓										
255533															✓		✓			✓		✓																																							
255539																	✓										✓	✓	✓	✓	✓																														
256865																	✓										✓	✓	✓	✓	✓																														
255540																	✓										✓	✓	✓	✓	✓																														
256868																	✓										✓	✓	✓	✓	✓																														
255551															✓		✓	✓			✓	✓	✓																																						
257557															✓		✓	✓			✓	✓	✓																																						
255557																✓	✓							✓	✓	✓	✓	✓	✓	✓																															
256869																✓	✓							✓	✓	✓	✓	✓	✓	✓																															
255558																✓	✓							✓	✓	✓	✓	✓	✓	✓																															
256870																✓	✓							✓	✓	✓	✓	✓	✓	✓																															
255577															✓		✓			✓							✓	✓	✓	✓	✓																														
256871															✓		✓			✓							✓	✓	✓	✓	✓																														
255578															✓		✓			✓							✓	✓	✓	✓	✓																														
256872															✓		✓			✓							✓	✓	✓	✓	✓																														
255591															✓	✓					✓		✓																																						
255592															✓	✓					✓		✓																																						
237908																																																													
255616																																																													
255618													✓																																																
255696	✓	✓	✓	✓			✓	✓	✓	✓	✓	✓	✓	✓																																															
257559	✓	✓	✓	✓			✓	✓	✓	✓	✓	✓	✓	✓																																															
16F205	✓	✓	✓		✓										✓		✓							✓			✓	✓		✓	✓																														

Kit Descriptions

Kit	Description
255507	Complete Seal Kit; Severe Duty, L100CS
256866	Complete Seal Kit; Severe Duty, L100SS
255508	Complete Seal Kit; MaxLife, L100CM
256867	Complete Seal Kit; MaxLife, L100SM
16F205	Complete Seal Kit; PTFE Alternative; includes all PTFE Alternative kits listed under Packing Kits , page 6
255523	Throat Seal Kit; Severe Duty
255524	Throat Seal Kit; MaxLife, L100CM
257558	Throat Seal Kit; MaxLife, L100SM
255533	Piston Seal Kit
255539	Intake Kit; Severe Duty, L100CS
256865	Intake Kit; Severe Duty, L100SS
255540	Intake Kit; MaxLife, L100CM
256868	Intake Kit; MaxLife, L100SM
255551	Piston Seal Metal and Soft Kit CS and CM
257557	Piston Seal Metal and Soft Kit SS and SM
255557	Intake Valve Seal Metal and Soft Kit; Severe Duty, L100CS
256869	Intake Valve Seal Metal and Soft Kit; Severe Duty; L100SS
255558	Intake Valve Seal Metal and Soft Kit; MaxLife, L100CM
256870	Intake Valve Seal Metal and Soft Kit; MaxLife, L100SM
255569	Displacement Rod Kit; Severe Duty; see page 2 for parts included in kit
255570	Displacement Rod Kit; MaxLife; see page 2 for parts included in kit
255577	Priming Piston Rod Kit; Severe Duty, L100 CS
256871	Priming Piston Rod Kit; Severe Duty, L100 SS
255578	Priming Piston Rod Kit; MaxLife, L100CM
256872	Priming Piston Rod Kit; MaxLife, L100SM
255591	Cylinder Kit; L100SS and L100SM
255592	Cylinder Kit; L100CS and L100CM
255604	Outlet Kit, L100CS; see page 2 for parts included in kit
257561	Outlet Kit, L100SS; see page 2 for parts included in kit

Kit	Description
255610	Intake Cylinder Kit, L100CS; see page 2 for parts included in kit
257560	Intake Cylinder Kit, L100SS; see page 2 for parts included in kit
237908	Bleed Valve Kit; CS
255616	Bleed Valve Kit; SS
255618	Enclosed Wet Cup Seal Kit; MaxLife
255696	Enclosed Wet Cup Kit; MaxLife
257559	Enclosed Wet Cup Kit; MaxLife, SS

Packing Kits

Throat Packings

Severe Duty

Ref.	Description	Qty.
5	★☒ GLAND, packing female; cs	1
	☒✘ GLAND, packing, female; sst	1
6	V-PACKING; UHMWPE	3
7	V-PACKING; PTFE	2
8	★☒ GLAND, packing male; cs	1
	☒✘ GLAND, packing male; sst	1

MaxLife

Ref.	Description	Qty.
5	SEAL, u-cup	1
6	★☒ SPACER, cs	1
	☒✘ SPACER, sst	1
7	SPACER, acetal	1

Severe Duty

* Lips face down

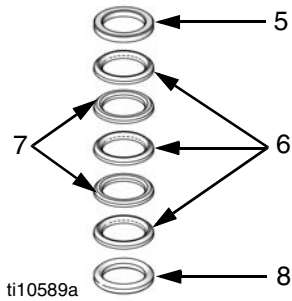

MaxLife

* Lips face down

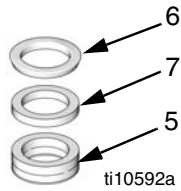

PTFE Alternative

Ref.	Description	Qty.
5	GLAND, packing, female	1
6	V-PACKING, PTFE	5
8	GLAND, packing, male	1

* Lips face down

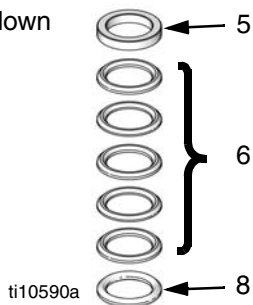

Intake Valve Packings

Severe Duty and MaxLife

Ref.	Description	Qty.
34	★☒ GLAND, male, priming piston; cs	1
	☒✘ GLAND, male, priming piston; sst	1
35	PACKING; UHMWPE	2
36	★* PACKING; PTFE	2
	☒✘ PACKING; leather	2
37	★☒ GLAND, female, priming piston; cs	1
	☒✘ GLAND, female, priming piston; sst	1

★ Model L100CS only.

* Model L100SS only.

☒ Model L100CM only.

✘ Model L100SM only.

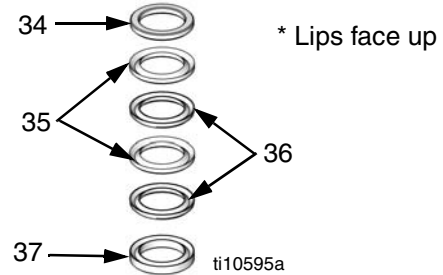

PTFE Alternative

Ref.	Description	Qty.
34	GLAND, male, priming piston	1
35	PACKING, PTFE	4
37	GLAND, female, priming piston	1

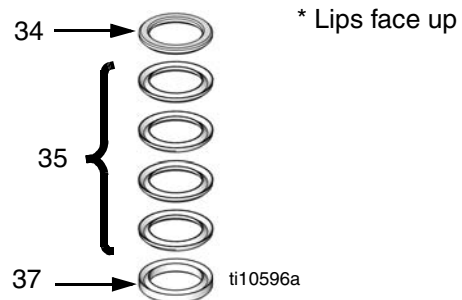

Piston Packings

PTFE Alternative

Ref.	Description	Qty.
31	SEAL, piston	1

All written and visual data contained in this document reflects the latest product information available at the time of publication. Graco reserves the right to make changes at any time without notice.

Original instructions. This manual contains English. MM 312467

Graco Headquarters: Minneapolis
International Offices: Belgium, China, Japan, Korea

GRACO INC. AND SUBSIDIARIES • P.O. BOX 1441 • MINNEAPOLIS MN 55440-1441 • USA

Copyright 2007, Graco Inc. All Graco manufacturing locations are registered to ISO 9001.

www.graco.com
Revised 01/2012