

Repair Parts for Xtreme™ and XP Xtreme 145cc Lowers

406890F
EN



Important Safety Instructions

Read all warnings and instructions in manual 311762. Save those instructions.

24F971 Xtreme™ Seal Repair Kit

262510 Tuff-Stack™ Seal Repair Kit

262791 X-Tuff® Seal Repair Kit

Bulk Pack Replacement Parts

- ① Torque to 115-135 ft-lb (155-182 N•m).
- ② 24F971 and 262791 - Torque to 25-30 ft-lb (34-41 N•m).
262510 - Torque to 125 ft-lb (169 N•m).
- ③ Torque to 140-150 ft-lb (189-203 N•m).
- ④ Torque to 40-60 ft-lb (52-82 N•m).
- ⑤ Apply lubricant to threads before assembly.
- ⑥ Lubricate.
- ⚠ Circular groove on caps indicates pump series.
- 8. Thick, medium, and thin refers to the relative cross-section thickness of the o-rings.

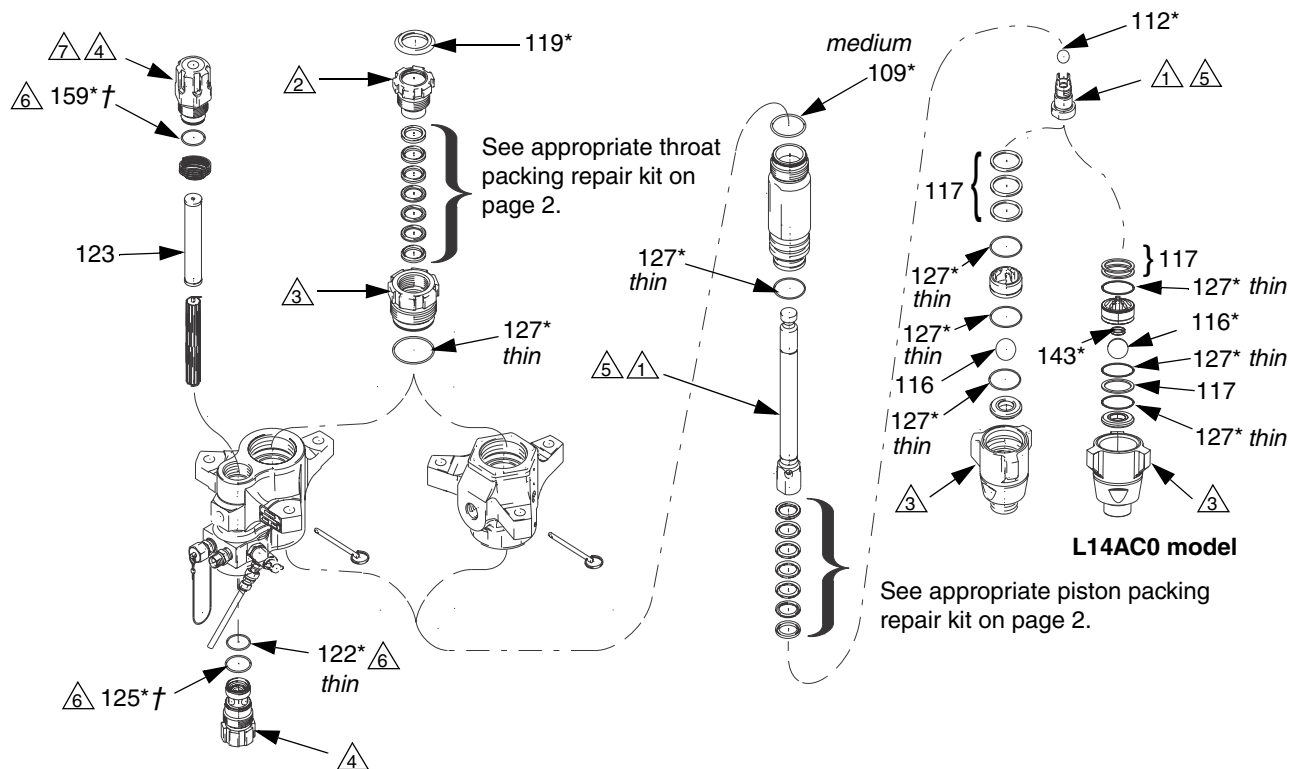

Bulk Pack Replacement Parts

Ref.	Part	Description	Qty
103*	---	THROAT PACKINGS	1
104*	---	PISTON PACKINGS	1
109*	244892	O-RING, PTFE, top cylinder; medium (10/pack)	1
112*	253029	BALL, piston, 3/4 in. (19 mm) diameter (3/pack)	1
116*	245128	BALL, inlet, 1-1/4 in. (32 mm) diameter (3/pack)	1
117	244855	SHIM, inlet, ball guide (9/pack)	3
119*	244996	PLUG, throat seal, 1.75 in. (10/pack)	1
119*	247394	PLUG, throat seal 2.5 in. (10/pack)	1
122*	244895	O-RING, filter; thin, PTFE (10/pack)	1
123	238436	STRAINER, 30 mesh screen (25/pack)	1
123	224458	STRAINER, 30 mesh screen (2/pack)	1
123	238438	STRAINER, 60 mesh screen (25/pack)	1
123	224459	STRAINER, 60 mesh screen (2/pack)	1
125*†	---	O-RING, filter; medium, PTFE (10/pack)	1
127*	244890	O-RING, PTFE, thin (10/pack)	5
143*	116801	SPRING, foot valve; 262510 and 262791 only	1
159*†	---	O-RING, filter, thick; PTFE (10 pack)	1

* Included in Seal Repair Kits.

† Refer to manual 406882 to match correct o-ring with pump series. Discard unused o-rings; they do not fit different series pumps.

Thick, medium, and thin refers to the relative cross-section thickness of the o-rings.

NOTE: The L14AC0 model uses a 30 mesh filter.

Tuff-Stack™ Seal Repair Kit 262510

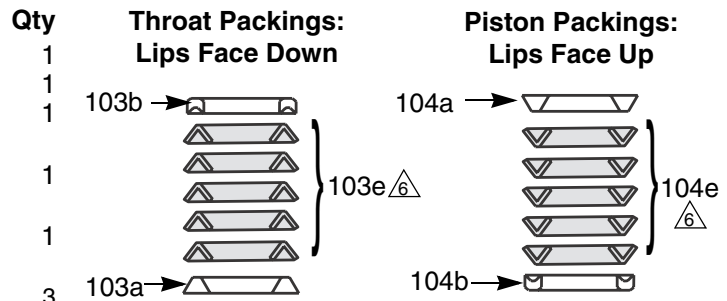

Lubricate Packings

Ref.	Part	Description	Qty.
103a	244881	GLAND, male (4/pack)	1
103b	244875	GLAND, female (4/pack)	1
103e	244857	V-PACKING, carbon-billed PTFE (10/pack)	5
104a	244881	GLAND, male (4/pack)	1
104b	244875	GLAND, female (4/pack)	1
104e	244857	V-PACKING, carbon-filled PTFE (10/pack)	5

Xtreme™ Seal Repair Kit 24F971

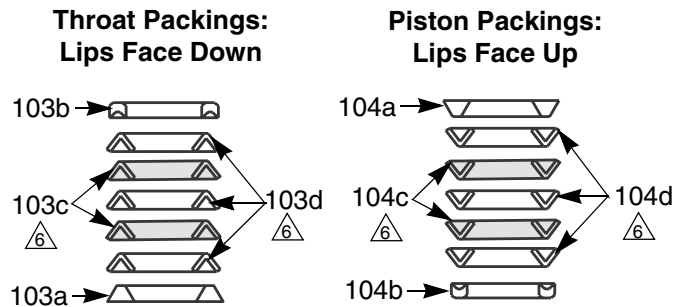

Lubricate Packings

(soak leather packings in oil for 1 hour)

Ref.	Part	Description	Qty.
103a	244881	GLAND, male (4 pack)	1
103b	244875	GLAND, female (4 pack)	1
103c	244869	V-PACKING, leather (10 pack)	2
103d	244863	V-PACKING, UHMWPE (10 pack)	3
104a	244881	GLAND, male (4 pack)	1
104b	244875	GLAND, female (4 pack)	1
104c	244869	V-PACKING, leather (10 pack)	2
104d	244863	V-PACKING, UHMWPE (10 pack)	3

X-Tuff® Seal Kit 262791

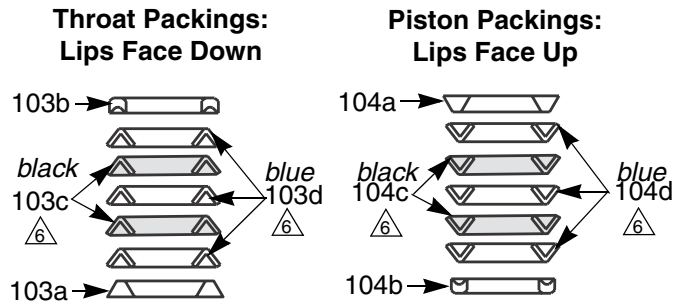

Lubricate Packings

Ref.	Part	Description	Qty.
103a	244881	GLAND, male (4 pack)	1
103b	244875	GLAND, female (4 pack)	1
103c	244857	V-PACKING, carbon-filled PTFE (10 pack)	2
103d	244863	V-PACKING, UHMWPE (10 pack)	3
104a	244881	GLAND, male (4 pack)	1
104b	244875	GLAND, female (4 pack)	1
104c	244857	V-PACKING, carbon-filled PTFE (10 pack)	2
104d	244863	V-PACKING, UHMWPE (10 pack)	3

*All written and visual data contained in this document reflects the latest product information available at the time of publication.
Graco reserves the right to make changes at any time without notice.*

For patent information, see www.graco.com/patents.

Original instructions. This manual contains English. MM 406890

Graco Headquarters: Minneapolis

International Offices: Belgium, China, Japan, Korea

GRACO INC. AND SUBSIDIARIES • P.O. BOX 1441 • MINNEAPOLIS MN 55440-1441 • USA
Copyright 2010, Graco Inc. All Graco manufacturing locations are registered to ISO 9001.

www.graco.com

Revised 18 May 2012