

Repair Parts for Xtreme™ and XP Xtreme 115cc Lower

406889E
EN



Important Safety Instructions

Read all warnings and instructions in manual 311762. Save those instructions.

24F972 Xtreme™ Seal Repair Kit

262508 Tuff-Stack™ Seal Repair Kit

262790 X-Tuff® Seal Repair Kit

Bulk Pack Replacement Parts

- ① Torque to 115-135 ft-lb (155-182 N•m)
- ② For 24F972 and 262790, torque to 25-30 ft-lb (34-41 N•m). For 262508, torque to 125 ft-lb (169 N•m).
- ③ Torque to 140-150 ft-lb (189-203 N•m)
- ④ Torque to 40-60 ft-lb (52-82 N•m)
- ⑤ Apply lubricant to threads before assembly.
- ⑥ Lubricate
- ⑦ Circular groove on caps indicates pump series.
- 8. Thick, medium, and thin refers to the relative cross-section thickness of the o-rings.
- ⑨ Pumps with short filters can be upgraded with kit 24F975.

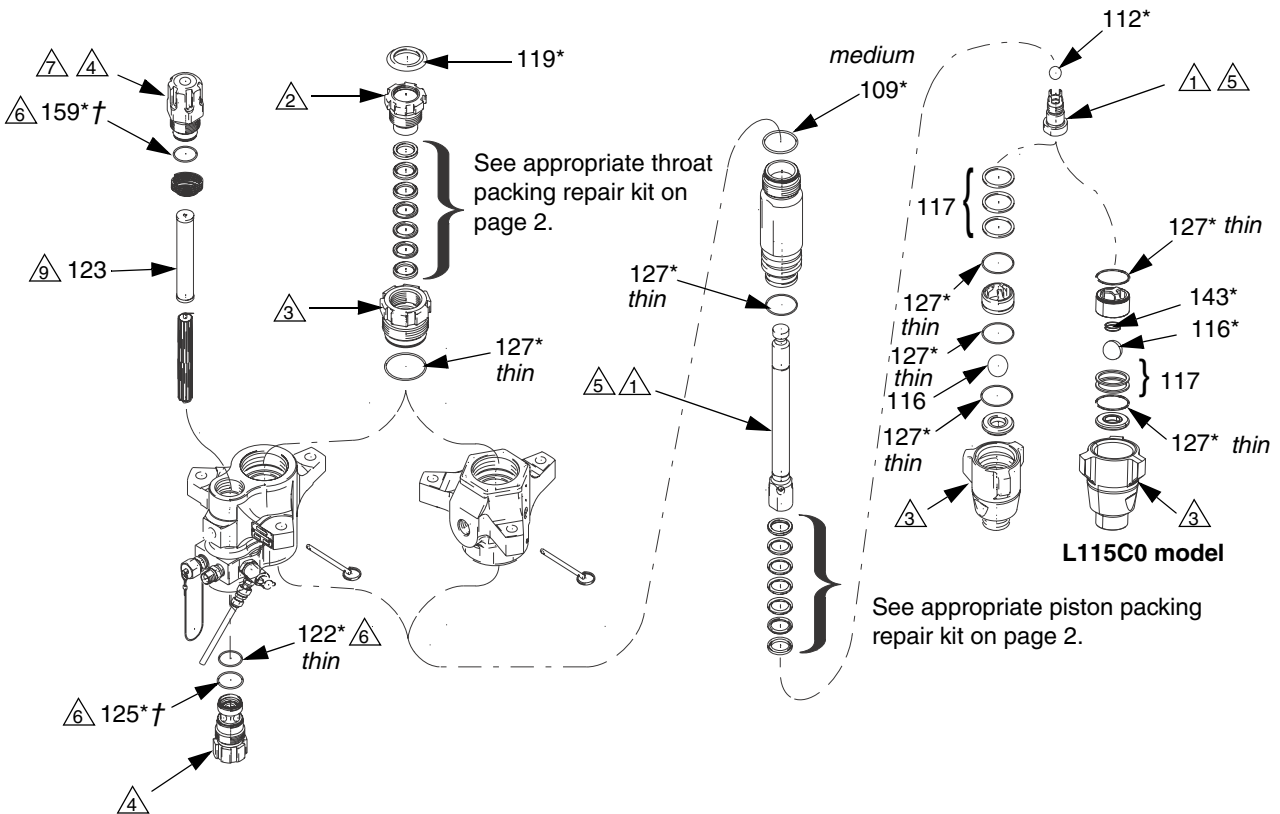

Bulk Pack Replacement Parts

Ref.	Part	Description	Qty.
103*	---	THROAT PACKINGS	1
104*	---	PISTON PACKINGS	1
109*	288067	O-RING, PTFE, top cylinder; medium (10/pack)	1
112*	288065	BALL, piston (3/pack)	1
116*	244899	BALL, inlet (3/pack)	1
117	288064	SHIM, inlet, ball guide (9/pack)	2 or 3
119*	247393	PLUG, throat seal (10/pack)	1
122*	244895	O-RING, filter; thin, PTFE (10/pack)	1
123	224458	STRAINER, 30 mesh screen (2/pack)	1
123	238436	STRAINER, 30 mesh screen (25/pack)	1
123	238438	STRAINER, 60 mesh screen (25/pack)	1
123	224459	STRAINER, 60 mesh screen (2/pack)	1
125*	---	O-RING, lower cap (10/pack)	1
127*	288068	O-RING, PTFE, thin(10/pack)	4 or 5
143*	124007	SPRING, foot valve; 262508 and 262790 only	1
159*	---	O-RING, top cap (10 pack)	1

* Included in Seal Repair Kits.

† Refer to manual 406882 to match correct o-ring with pump series. Discard unused o-rings; they do not fit different series pumps.

Thick, medium, and thin refers to the relative cross-section thickness of the o-rings.

NOTE: The L115C0 model uses a 30 mesh filter.

Tuff-Stack™ Seal Repair Kit 262508

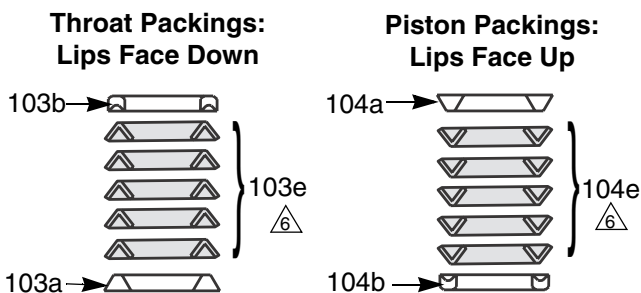

Lubricate Packings

Ref.	Part	Description	Qty.
103a	288074	GLAND, male (4/pack)	1
103b	288073	GLAND, female (4/pack)	1
103e	288066	V-PACKING, carbon-filled PTFE, throat (10/pack)	5
104a	288074	GLAND, male, (4/pack)	1
104b	288073	GLAND, female (4/pack)	1
104e	288066	V-PACKING, carbon-filled PTFE, piston (10/pack)	5

Xtreme™ Seal Repair Kit 24F972

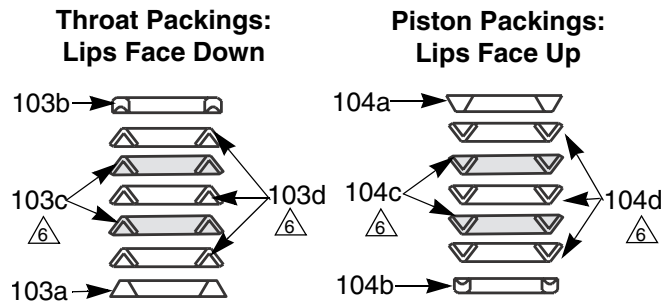

Lubricate Packings
(soak leather packings in oil for 1 hour)

Ref.	Part	Description	Qty.
103a	288074	GLAND, male (4 pack)	1
103b	288073	GLAND, female (4 pack)	1
103c	288076	V-PACKING, leather (10 pack)	2
103d	288075	V-PACKING, UHMWPE (10 pack)	3
104a	288074	GLAND, male (4 pack)	1
104b	288073	GLAND, female (4 pack)	1
104c	288076	V-PACKING, leather (10 pack)	2
104d	288075	V-PACKING, UHMWPE (10 pack)	3

X-Tuff® Seal Repair Kit 262790

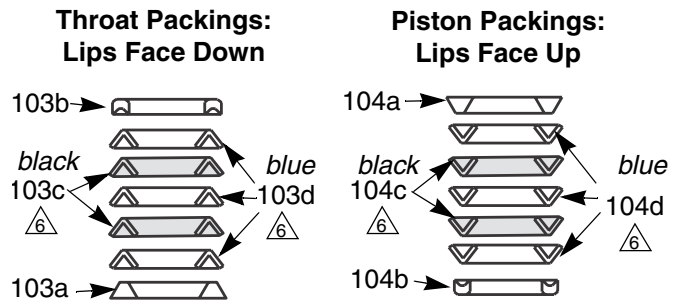

Lubricate Packings

Ref.	Part	Description	Qty.
103a	288074	GLAND, male (4 pack)	1
103b	288073	GLAND, female (4 pack)	1
103c	288066	V-PACKING, carbon-filled PTFE (10 pack)	2
103d	288075	V-PACKING, UHMWPE (10 pack)	3
104a	288074	GLAND, male (4 pack)	1
104b	288073	GLAND, female (4 pack)	1
104c	288066	V-PACKING, carbon-filled PTFE (10 pack)	2
104d	288075	V-PACKING, UHMWPE (10 pack)	3

*All written and visual data contained in this document reflects the latest product information available at the time of publication.
Graco reserves the right to make changes at any time without notice.*

For patent information, see www.graco.com/patents.

Original instructions. This manual contains English. MM 406889

Graco Headquarters: Minneapolis

International Offices: Belgium, China, Japan, Korea

GRACO INC. AND SUBSIDIARIES • P.O. BOX 1441 • MINNEAPOLIS MN 55440-1441 • USA
Copyright 2010, Graco Inc. All Graco manufacturing locations are registered to ISO 9001.

www.graco.com

Revised 18 May 2012