

RPS 2900 OEM Kit

3A1303B
EN

- Use with Architectural Coating, Paints, Roof Coatings and Below Grade Coatings -

Part No. 24G767

4000 psi (27.6 MPa, 275.8 bar) Maximum Working Pressure (Material Working PSI)



Important Safety Instructions

For complete warnings and safety instructions, see RoadLazer™ RoadPak™ Line Striping System manual. Save these instructions.

Technical Data

Paint/Hydraulic Ratio	1.45:1
User Supplied Input	
•Max Hydraulic Pressure	2750 psi (190 bar, 19.0 MPa)
•Hydraulic Flow Required	6.25 gpm (23.6 lpm)
Unit Output	
•Max Fluid Pressure	4000 psi (275 bar, 27.6 MPa)
•Max Flow	4 gpm (15.1 lpm)
Max Cycle Rate	64 cpm
Dimensions	
Height	39.5 in. (1003 mm)
Width	7.5 in. (190.5 mm)
Depth	5.5 in. (140 mm)
Weight	63 lbs (28.6 kg)

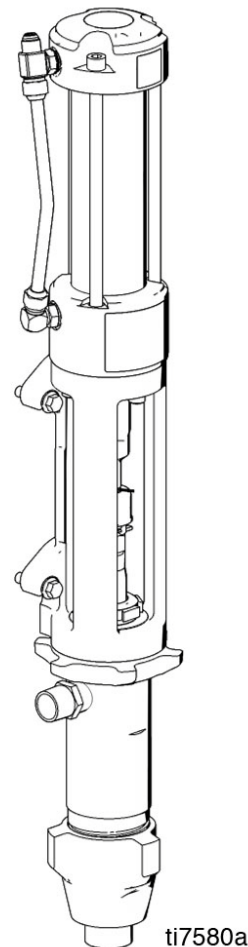

Parts

FN	Part No.	Description	Qty	FN	Part No.	Description	Qty
				105	117607	FITTING, elbow std thd	1
7	120226	SCREW, hex hd, flange	4	106	117609	FITTING, tee, branch, str thd	1
36	287834	KIT, pump, displacement, includes 141	1	121	116407	CLIP, hairpin	1
40	116554	WASHER, flat	1	122	15G204	NUT, retaining	1
42	15G501	SLEEVE, valve, hydr, motor	1	124	197340	COVER, coupler	1
43	15G503	STOP, valve, hydraulic motor	1	125	244819	COUPLING, assembly	1
44	15D256	SCREW, cap, sch	2	141	15H335	FITTING, nipple, 1 in. npt, includes 36	1
45	101947	BALL, bearing	2	169	15G877	LABEL, front	1
46	15G270	YOKE, arm, hydraulic motor	2	▲			
48	105270	SCREW, shoulder, sch	4	170	15G878	LABEL, Graco logo	1
52	287869	CYLINDER, hydraulic motor	1	175	15B063	LABEL, includes 75	1
53	287870	KIT, repair, packing, hydraulic, includes 62	1	▲			
53a		BEARING, piston	1	163‡	15H201	SHIELD, pump	1
53b		O-RING, piston	1	†			
53c		SEAL, piston, hydraulic motor	1	164‡	111235	SCREW, mach, pnh	1
53d		SEAL, rod	1	165‡	120317	NUT, wing	1
53e		BEARING, rod	1	▲	<i>Replacement Danger and Warning labels, tags, and cards are available at no cost.</i>		
5ef		WIPER, rod	1	‡	<i>Use on model 253473.</i>		
62	116084	PACKING, o-ring	2	Item	Description		
63	15G559	HOUSING, hydraulic motor, lower	1	△1	HYDRAULIC INLET, 3/4 in. - 16 UNF 2A, 37° flared male		
66	101970	PLUG, pipe	1	△2	HYDRAULIC RETURN, 1-1/6 in. - 12 UN 2A, 37° flared male		
73	15G639	ADAPTER, hydraulic motor/pump	1	△3	MOUNTING SLOT, 4X, 7/16 in. - 14 UNC 2B, flange head, cap screw, 1-3/4 in. long recommended (Graco PN 120226)		
74	120202	SCREW, cap sch	3	△4	1 in. - 11-1/2 NPT Female		
75	288061	CAP, hydraulic head, includes 175	1	△5	1-1/2 in. - 11-1/2 NPT Male		
76	287868	PISTON, hydraulic	1				
90	120138	SCREW, cap, socket head	3				
91	120146	SPRING, compression	1				
97	287841	TUBE	1				
104	120065	FITTING, hydraulic	1				

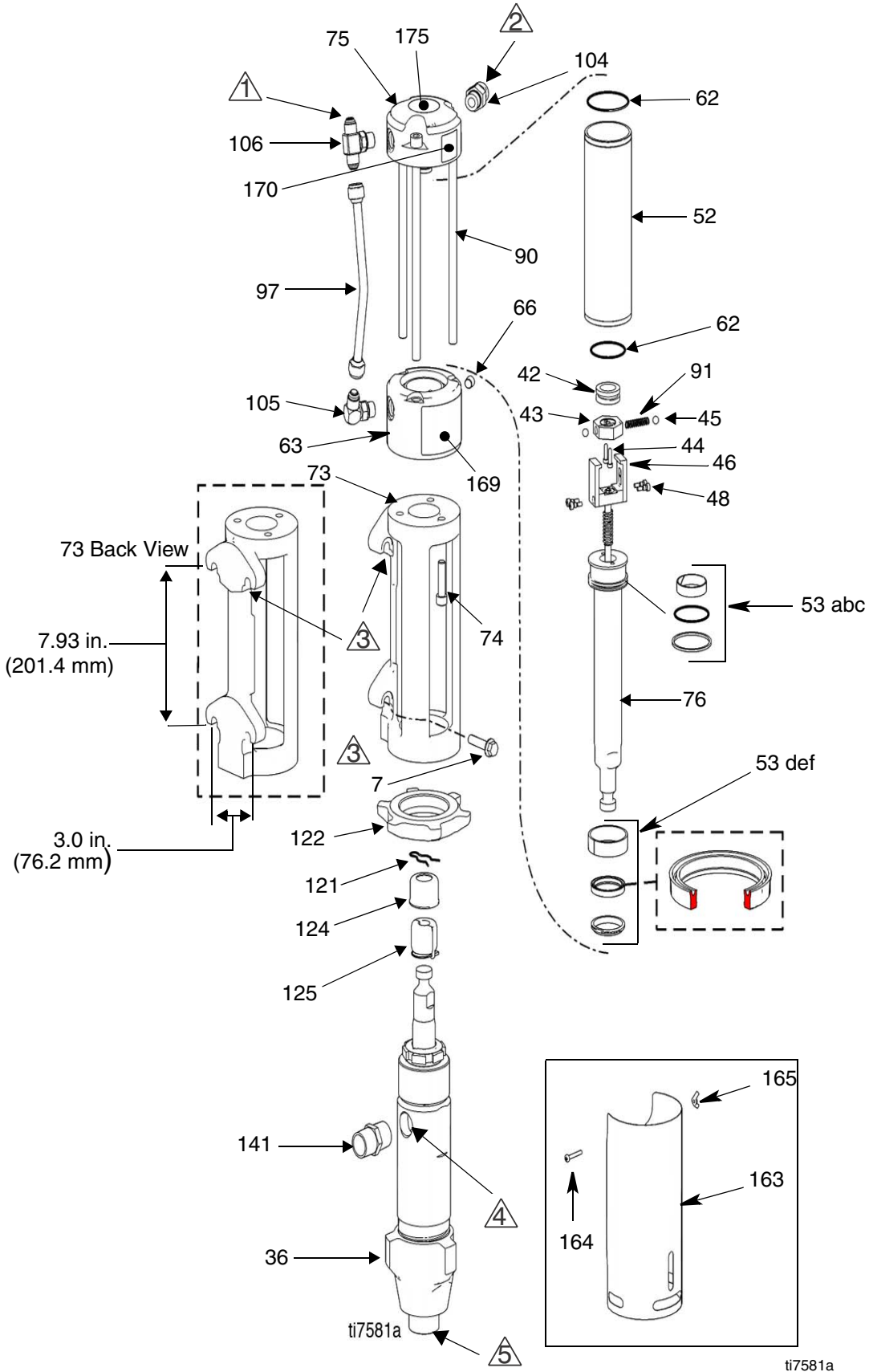

*All written and visual data contained in this document reflects the latest product information available at the time of publication.
Graco reserves the right to make changes at any time without notice.*

For patent information, see www.graco.com/patents.

Original instructions. This manual contains English. MM 3A1303

Graco Headquarters: Minneapolis

International Offices: Belgium, China, Japan, Korea

GRACO INC. AND SUBSIDIARIES • P.O. BOX 1441 • MINNEAPOLIS MN 55440-1441 • USA

Copyright 2010, Graco Inc. All Graco manufacturing locations are registered to ISO 9001.

www.graco.com
Revised September 2012