

Bead Tank Kit, Paint Tank Kit, and Accessory Frame Kit 3A1302D For RoadLazer™ RoadPak™ Line Striping System

EN

- Model 24G769 - Paint Tank Kit
- Model 24G765 - Bead Tank Kit
- Model 24H585 - Accessory Frame Kit



Important Safety Instructions

For complete warnings and safety instructions see RoadLazer™ RoadPak™ Line Striper System manual. Save these instructions.

Paint Tank Kit

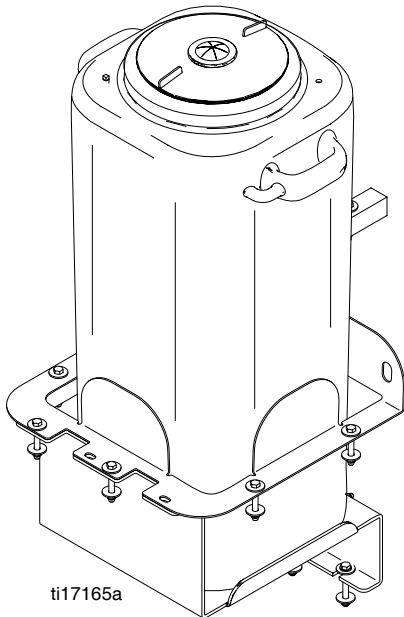

Bead Tank Kit

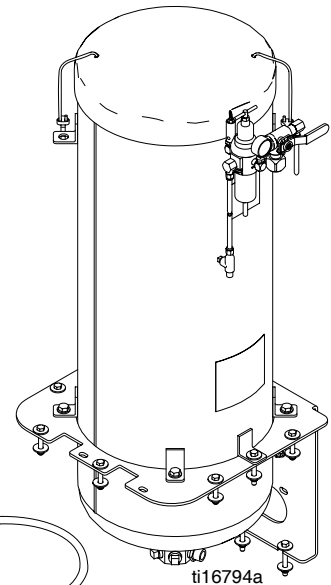

Accessory Frame Kit

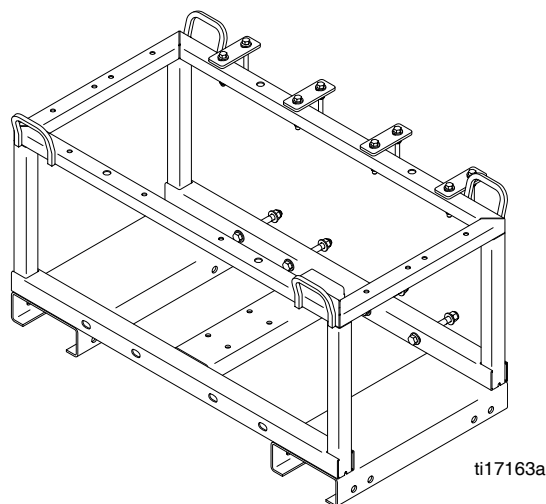
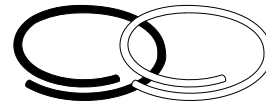

Pressure Relief Procedure



Follow the Pressure Relief Procedure whenever you see this symbol.

<p>The system pressure must be manually relieved to prevent the system from starting or spraying accidentally. Fluid under high pressure can be injected through the skin and cause serious injury. To reduce the risk of an injury from injection, splashing fluid, or moving parts, follow the Pressure Relief Procedure in manual 3A1214 whenever you:</p> <ul style="list-style-type: none"> • are instructed to relieve the pressure • stop spraying • check or service any of the system equipment • install or clean the spray tip 			

1. Relieve pressure. See **Pressure Relief Procedure** in manual 3A1214.

Second Bead Tank Installation

1. Place bead tank mounting bracket (2) into position on RoadPak frame.
2. Install three bolts (16) and washers (17) on bottom of bracket (2). Thread nuts (15) onto bolts and torque to 15 ft-lb (20.3 N•m).

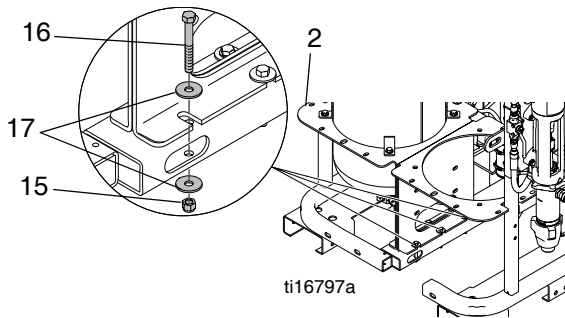

3. Install four bolts (18) and washers (17) to top of bracket (2). Thread nuts (15) onto bolts and torque to 15 ft-lb (20.3 N•m).

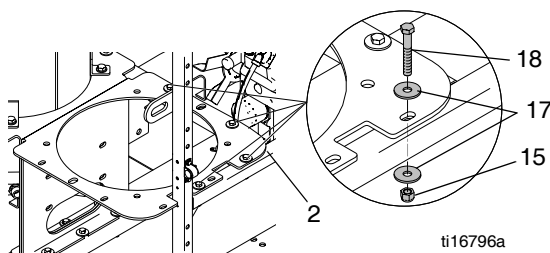

NOTE: If installing to accessory frame kit (24H585) install four bolts (18) and washers (17) to top of bracket (2). Thread nuts (15) onto bolts and torque to 15 ft-lb (20.3 N•m).

4. Use hoist (or other lifting equipment) to lift bead tank (1) and lower it into tank mounting bracket (2).

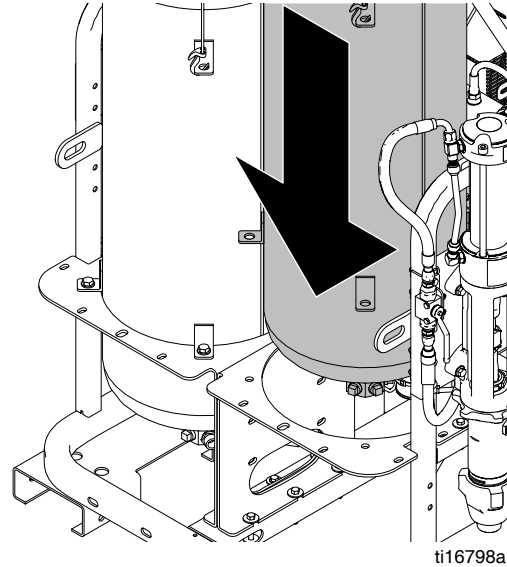

NOTE: Make sure bead tank is positioned with air regulator inlet facing toward inside of RoadPak.

5. Install four bolts (18) and washers (17) at each corner bead tank mount. Thread nut (15) onto bolts and torque to 27 ft-lb (36.6 N•m).

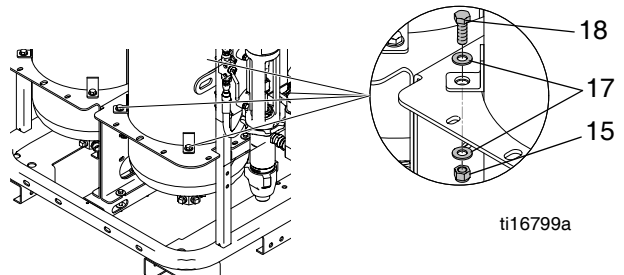

6. Install bolt (12) and washers (13) into center bead tank mount. Thread nut (14) onto bolt and torque to 15 ft-lb (20.3 N•m).

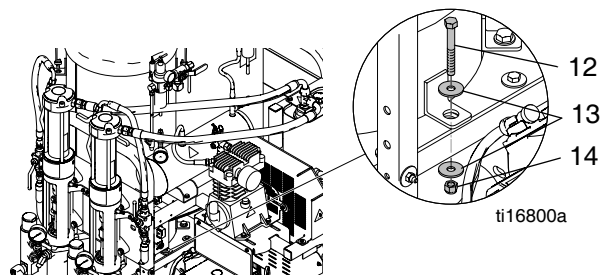

7. Connect air regulator assembly to bead tank air inlet and tighten swivel (22).

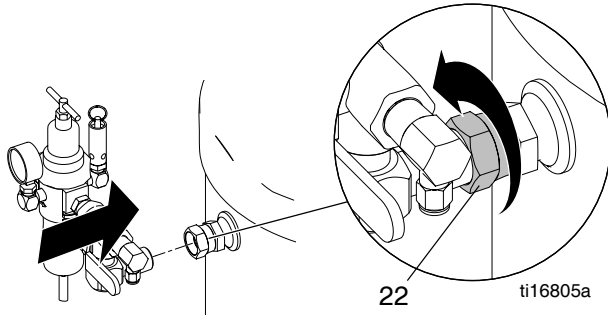

8. Remove plug (40) from T-fitting (39) assembled to air tank on RoadPak unit.

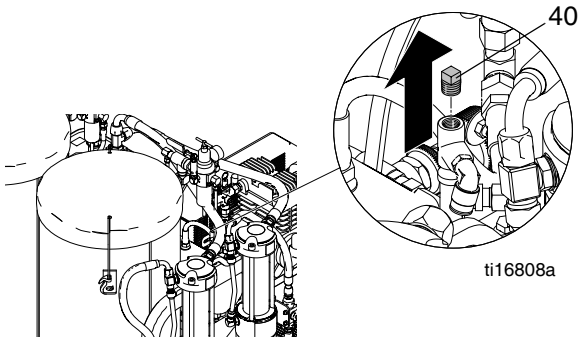

If assembling second bead tank to RoadPak frame:

9. Apply thread sealant to fitting (41) and tighten to T-fitting (39). Apply thread sealant to fitting (41) and tighten to elbow fitting (24). Connect coupled hose (42) to fittings (41).

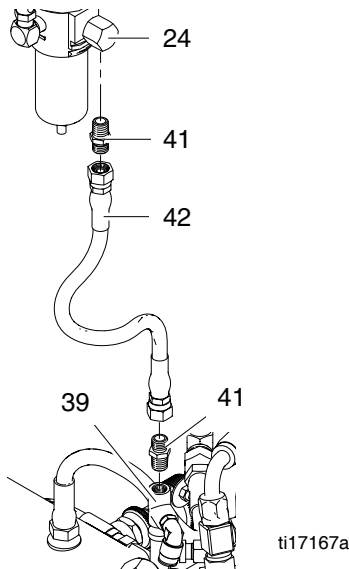

If assembling second bead tank to remote location:

10. Tighten air fitting (29) to T-fitting (39). Tighten air fitting (29) to elbow fitting (24). Cut air hose (31) to desired length and connect to air fittings (29).

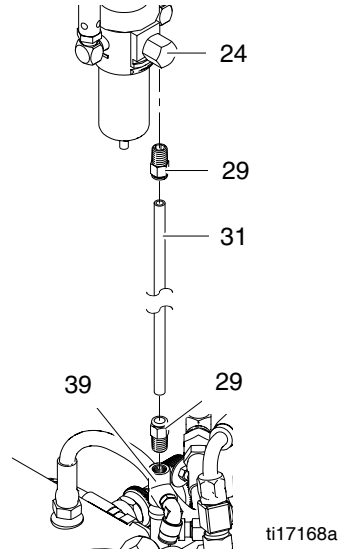

11. Connect dark hose (20) into air fitting (29) and clear hose (32) to bottom of air regulator (11). Route hoses through slot on tank bracket.

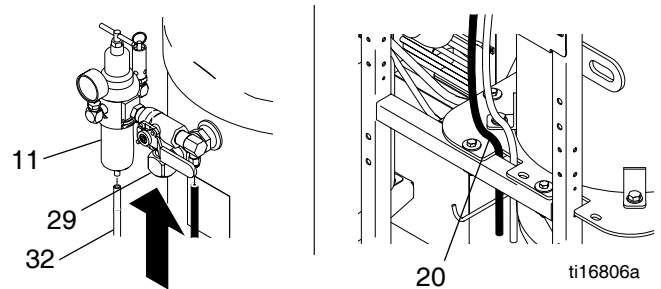

12. Connect bead hose (not included) to bottom of bead tank (1).

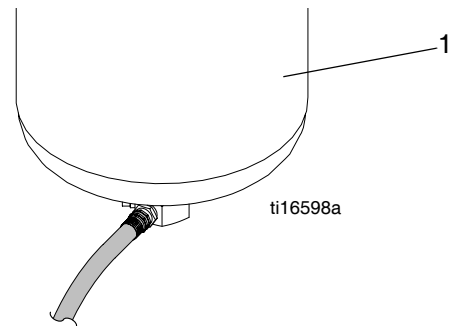

NOTE: Bead tank kit comes with two hose fittings (10) and three plugs (9) shipped with hose kit.

Parts

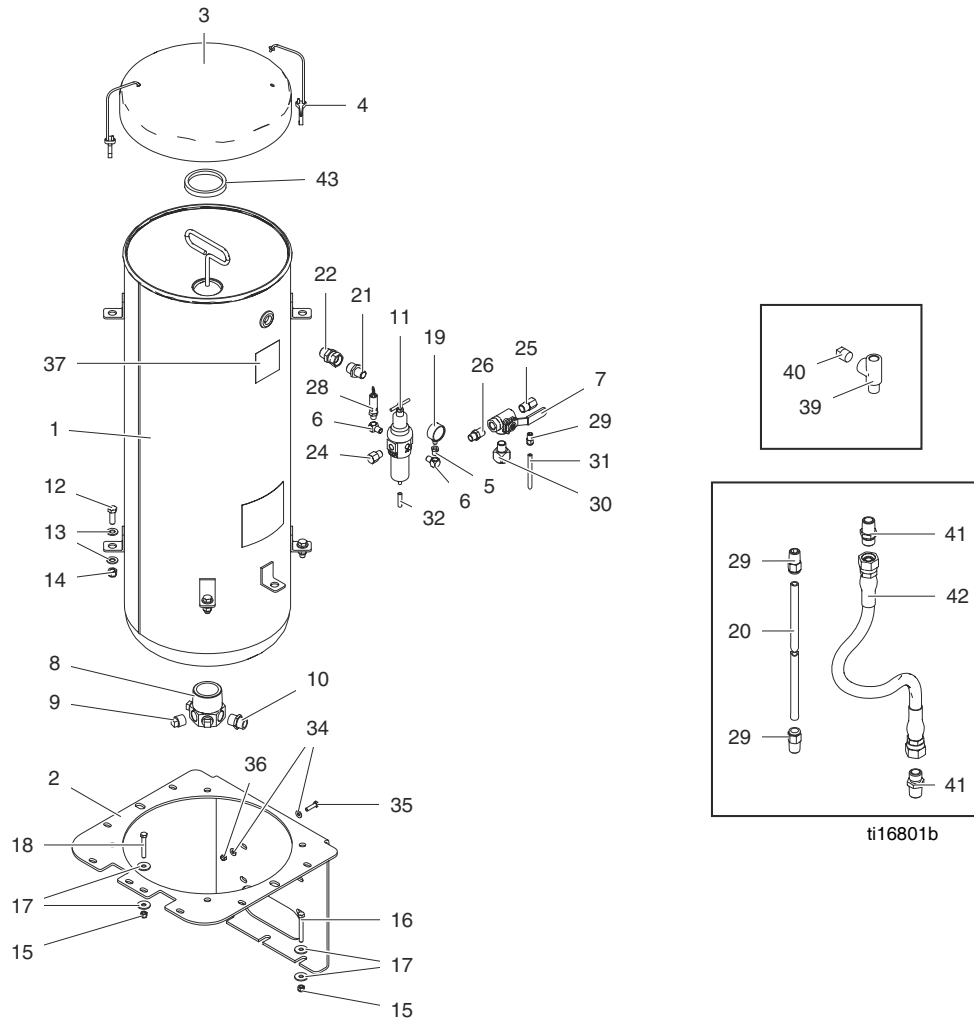

Ref.	Part	Description	Qty.	Ref.	Part	Description	Qty.
1	24F496	TANK, bead, 36 gal., painted	1	21	157191	FITTING, adapter (1/2 npt x 3/4 npt)	1
2	16G777	PLATE, mount, bead tank, painted	1	22	157785	FITTING, swivel	1
3	16G166	COVER, bead tank	1	24	164259	FITTING, elbow, street	1
4	119771	STRAP, cover	2	25	166999	FITTING, elbow, street	1
5	100030	BUSHING	1	26	159239	FITTING, nipple, pipe, rdcg	1
6	100840	FITTING, elbow, street	2	28	108124	VALVE, safety, 75 psi	1
7	113292	VALVE, ball, 3 way	1	29	113319	FITTING, air	3
8	191222	FITTING	1	30	158683	FITTING, elbow, 90 deg	1
9	104663	PLUG, pipe	3	31	191643	HOSE, air, 3/8	1
10	111834	NIPPLE, pipe, hex	1	32	16H355	TUBE, drain	1
11	113291	REGULATOR, air	1	34	100527	WASHER, plain	4
12	100017	SCREW, cap, hex hd	1	35	100521	SCREW, cap hex hd	2
13	109570	WASHER, plain	8	36	111040	NUT, lock, insert, nylock, 5/16	2
14	801020	NUT, lock, hex	4	37	16H060	LABEL, pressure on/off	1
15	101566	NUT, lock	10	39	106228	FITTING, tee, street	1
16	116935	SCREW, cap hex hd	4	40	100509	PLUG, pipe	1
17	108851	WASHER, plain	17	41	162453	FITTING, 1/4 npsm x 1/4 npt	1
18		BOLT, hex hd, 3/8 X 2.5	6	42	512616	HOSE, coupled, 061120	1
19	104655	GAUGE, press air	1	43	15A552	SEAL, replacement	1
20	191267	HOSE, air	1				

‡ Used if mounting more than 2 bead tanks to system.

33 Gallon Paint Tank Kit (24G769)

If Installing to RoadPak Frame:

1. Place paint tank bracket (1) into position on frame.
2. Install three bolts (9) and washers (7) on bottom of support bracket (1). Thread nuts (8) onto bolts and torque to 15 ft-lb (20.3 N•m).

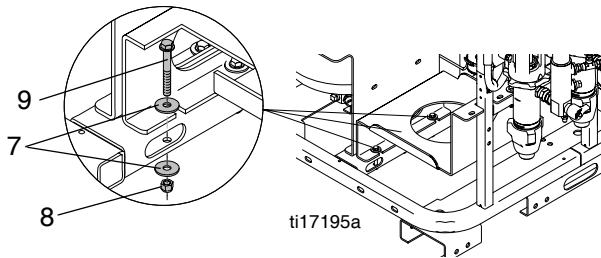

3. Install four bolts (6) and washer (7) to secure sleeve bracket (2) and support bracket (1) to the frame. Thread nuts (8) onto bolts and torque to 15 ft-lb.

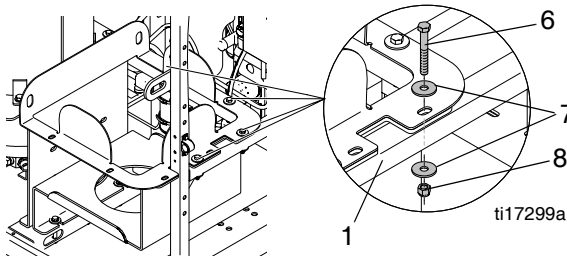

4. Install two bolts (6) and washer (7) to support bar (14) and paint tank bracket (2). Thread nuts (8) onto bolts and torque to 15 ft-lb (20.3 N•m). Install two bolts (6) and washer (7) to support bar (14) and to bead tank bracket. Thread nuts (8) onto bolts and torque to 15 ft-lb (20.3 N•m).

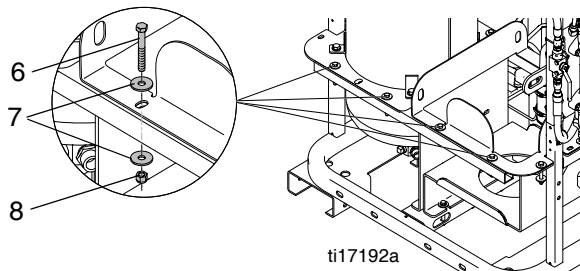

5. Insert paint tank (3) into sleeve bracket.

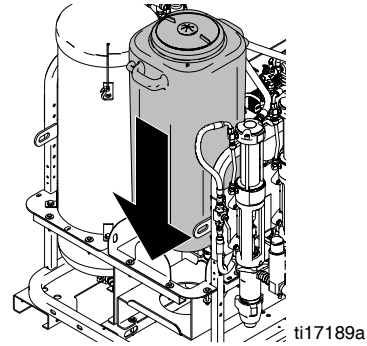

6. Secure paint tank with tie-down straps.

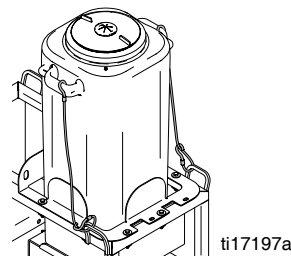

7. Insert suction tube (with strainer removed) through top grommet (5).

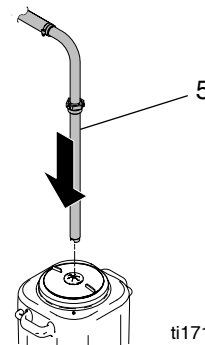

NOTE: Optional Bottom Feed Fittings Kit 24J149 is available for paint tank.

8. Connect strainer onto suction set. Strainer should be about 1/2 in. from bottom of suction set.

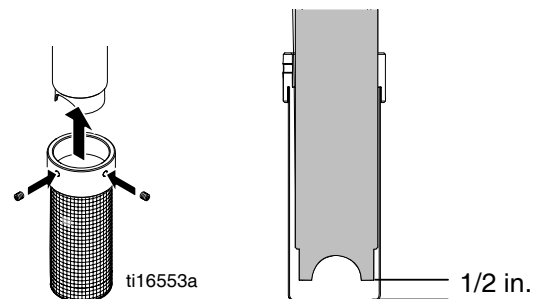

If Installing to RoadPak Accessory Frame:

1. Place paint tank bracket (1) into position on frame.
2. Install three bolts (9) and washers (7) on bottom of support bracket (1). Thread nuts (8) onto bolts and torque to 15 ft-lb (20.3 N•m).

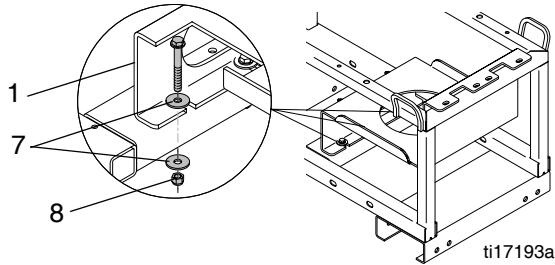

3. Install six bolts (6) and washer (7) to secure sleeve bracket (2) and support bracket (1) to the accessory frame. Thread nuts (8) onto bolts and torque to 15 ft-lb (20.3 N•m).

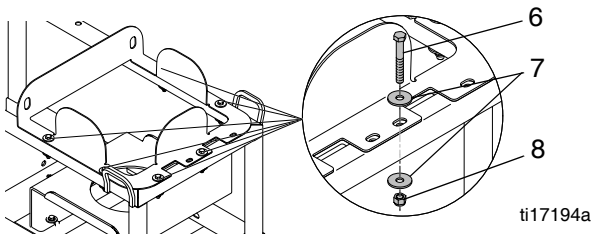

4. Insert paint tank (3) into sleeve bracket.

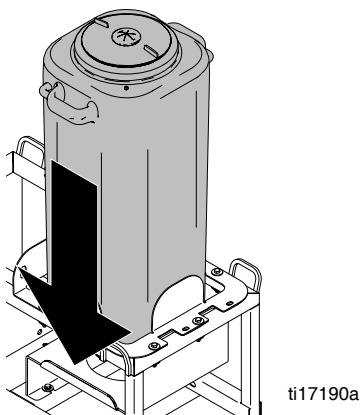

5. Secure paint tank with tie-down straps.

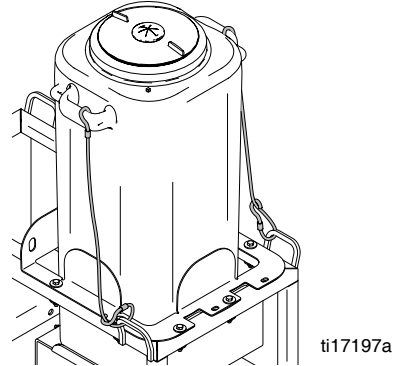

6. Insert suction tube (with strainer removed) through top grommet (5).

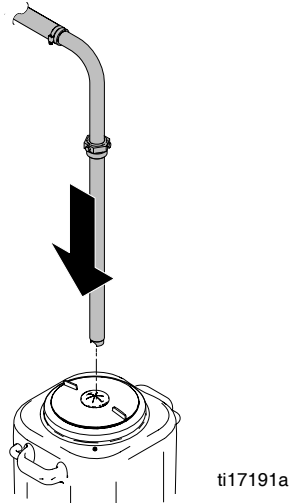

NOTE: Optional Bottom Feed Fittings Kit 24J149 is available for paint tank.

7. Connect strainer onto suction set. Strainer should be about 1/2 in. from bottom of suction set.

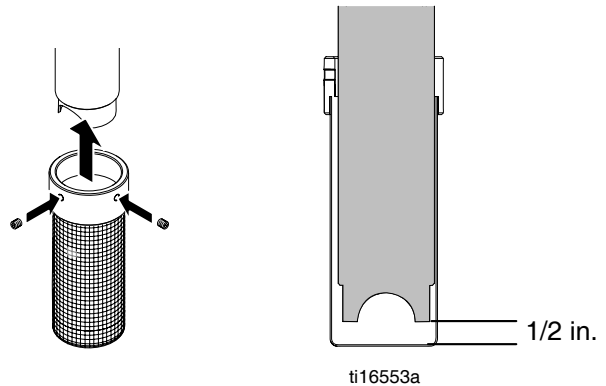

Parts

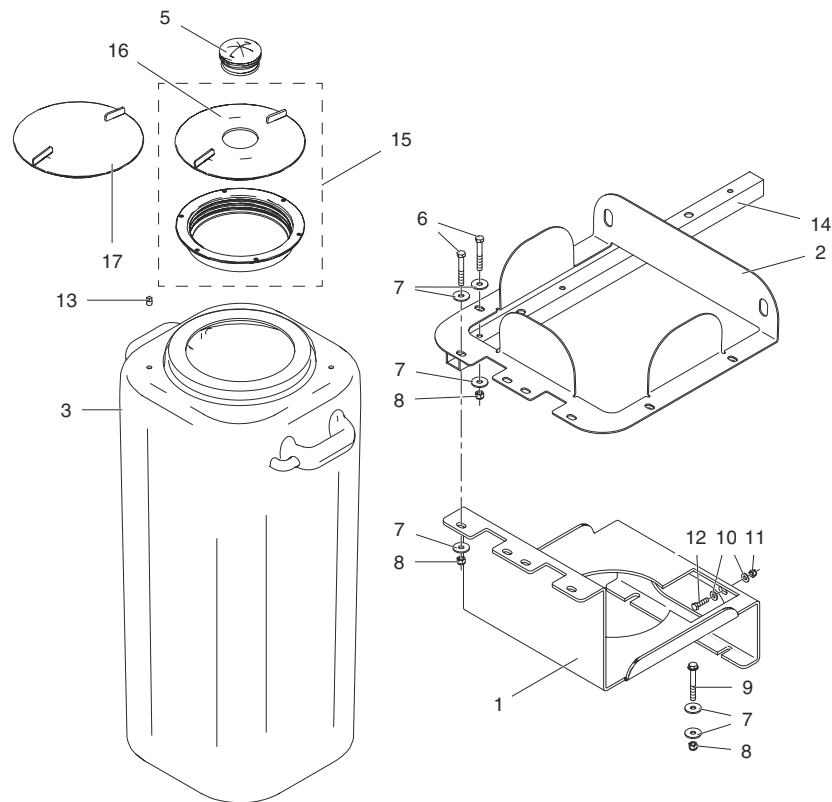

ti17166b

Parts List

Ref.	Part	Description	Qty.
1	24H831	BRACKET, Roadpak paint tank, painted	1
2	24H832	SLEEVE, Roadpak, painted	1
3	24J353	TANK, paint, with 8 in. man-way (includes 15)	1
5	194420	GROMMET, hopper	1
6	106212	SCREW, cap, hex HD	8
7	108851	WASHER, plain	22
8	101566	NUT, lock	11
9	116935	SCREW, cap, flnghd	3
10	100527	WASHER, plain	4
11	111040	NUT, lock, insert, Nylock, 5/16	2
12	100521	SCREW, cap hex HD	2
13	107570	PLUG, pipe, square HD	1
14	24J370	SUPPORT, paint tank sleeve, painted	1
15	16J474	COVER, with opening and bulk-head rim	1
16	16J473	COVER, with opening	1
17	125240	COVER, without opening	1

Accessory Frame Kit 24H585

Installation

1. Load assembled accessory frame to desired location on vehicle.
2. Secure the accessory frame by strapping all four corners down to the vehicle or by bolting the accessory frame to the RoadPak frame.

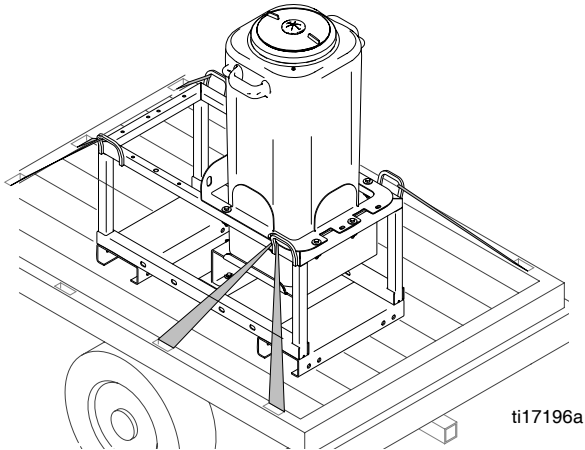

3. **If bolting to RoadPak frame:** Assemble four frame straps (2) to accessory frame (1) and to RoadPak frame by installing eight bolts (6) and washers (8). Thread nuts (9) onto bolts and torque to 15 ft-lb (20.3 N•m).

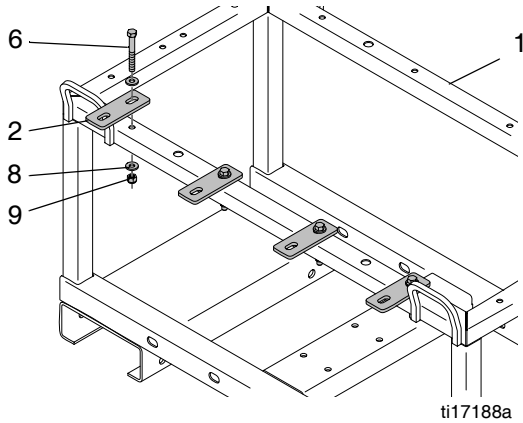

4. Install four bolts (3) and washers (4) to connect accessory frame (1) and RoadPak frame. Thread nuts (5) to bolts and torque to 27 ft-lb (36.6 N•m).

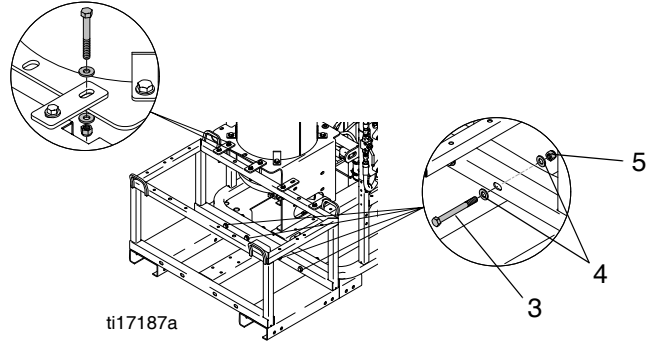

Parts

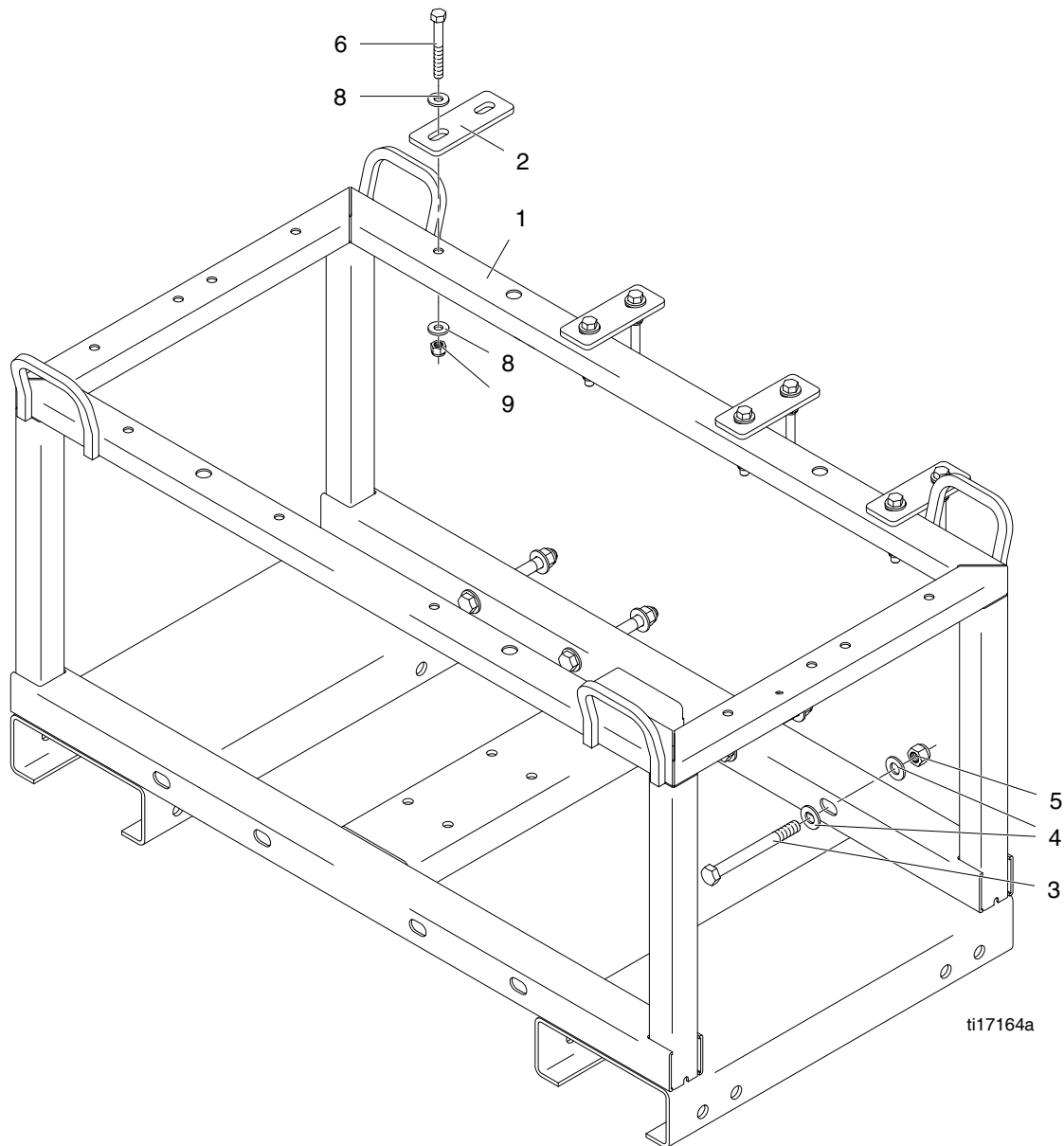

Parts List

Ref.	Part	Description	Qty.
1	24H826	FRAME, Roadpak accessory	1
2	24J016	STRAP, frame, painted	4
3	115211	SCREW, cap, hex HD	4
4	109570	WASHER, plain	8
5	801020	NUT, lock, hex	4
6	100454	SCREW, cap hex HD	8
8	100023	WASHER, flat	16
9	101566	NUT, lock	8

Graco Standard Warranty

Graco warrants all equipment referenced in this document which is manufactured by Graco and bearing its name to be free from defects in material and workmanship on the date of sale to the original purchaser for use. With the exception of any special, extended, or limited warranty published by Graco, Graco will, for a period of twelve months from the date of sale, repair or replace any part of the equipment determined by Graco to be defective. This warranty applies only when the equipment is installed, operated and maintained in accordance with Graco's written recommendations.

This warranty does not cover, and Graco shall not be liable for general wear and tear, or any malfunction, damage or wear caused by faulty installation, misapplication, abrasion, corrosion, inadequate or improper maintenance, negligence, accident, tampering, or substitution of non-Graco component parts. Nor shall Graco be liable for malfunction, damage or wear caused by the incompatibility of Graco equipment with structures, accessories, equipment or materials not supplied by Graco, or the improper design, manufacture, installation, operation or maintenance of structures, accessories, equipment or materials not supplied by Graco.

This warranty is conditioned upon the prepaid return of the equipment claimed to be defective to an authorized Graco distributor for verification of the claimed defect. If the claimed defect is verified, Graco will repair or replace free of charge any defective parts. The equipment will be returned to the original purchaser transportation prepaid. If inspection of the equipment does not disclose any defect in material or workmanship, repairs will be made at a reasonable charge, which charges may include the costs of parts, labor, and transportation.

THIS WARRANTY IS EXCLUSIVE, AND IS IN LIEU OF ANY OTHER WARRANTIES, EXPRESS OR IMPLIED, INCLUDING BUT NOT LIMITED TO WARRANTY OF MERCHANTABILITY OR WARRANTY OF FITNESS FOR A PARTICULAR PURPOSE.

Graco's sole obligation and buyer's sole remedy for any breach of warranty shall be as set forth above. The buyer agrees that no other remedy (including, but not limited to, incidental or consequential damages for lost profits, lost sales, injury to person or property, or any other incidental or consequential loss) shall be available. Any action for breach of warranty must be brought within two (2) years of the date of sale.

GRACO MAKES NO WARRANTY, AND DISCLAIMS ALL IMPLIED WARRANTIES OF MERCHANTABILITY AND FITNESS FOR A PARTICULAR PURPOSE, IN CONNECTION WITH ACCESSORIES, EQUIPMENT, MATERIALS OR COMPONENTS SOLD BUT NOT MANUFACTURED BY GRACO. These items sold, but not manufactured by Graco (such as electric motors, switches, hose, etc.), are subject to the warranty, if any, of their manufacturer. Graco will provide purchaser with reasonable assistance in making any claim for breach of these warranties.

In no event will Graco be liable for indirect, incidental, special or consequential damages resulting from Graco supplying equipment hereunder, or the furnishing, performance, or use of any products or other goods sold hereto, whether due to a breach of contract, breach of warranty, the negligence of Graco, or otherwise.

FOR GRACO CANADA CUSTOMERS

The Parties acknowledge that they have required that the present document, as well as all documents, notices and legal proceedings entered into, given or instituted pursuant hereto or relating directly or indirectly hereto, be drawn up in English. Les parties reconnaissent avoir convenu que la rédaction du présente document sera en Anglais, ainsi que tous documents, avis et procédures judiciaires exécutés, donnés ou intentés, à la suite de ou en rapport, directement ou indirectement, avec les procédures concernées.

Graco Information

For the latest information about Graco products, visit www.graco.com.

TO PLACE AN ORDER, contact your Graco distributor or call 1-800-690-2894 to identify the nearest distributor.

All written and visual data contained in this document reflects the latest product information available at the time of publication. Graco reserves the right to make changes at any time without notice.

For patent information, see www.graco.com/patents.
Original instructions. This manual contains English. MM 3A1302

Graco Headquarters: Minneapolis
International Offices: Belgium, China, Japan, Korea
GRACO INC. P.O. BOX 1441 MINNEAPOLIS, MN 55440-1441

Copyright 2010, Graco Inc. is registered to ISO 9001
www.graco.com
Revised December 2013